

# 2D/2C Dimmable electronic ballast

38W, 55W – AC230V

Model: WTEB-D series

- Input voltage: AC220V ~ 240V
- Lamp type : 38w & 55w 2D/2C lamp
- Start-up: pre-heating
- Power factor: > 0.97
- Certificate: TUV approval
- Protection: over-current, over-voltage and short-circuit.

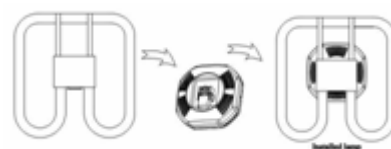

Wiring diagram:

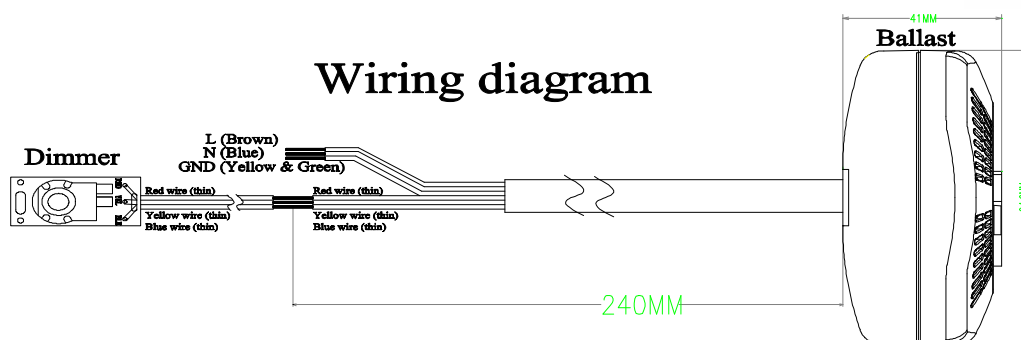

Specifications:

Model Name	WTEB-D138D-230 38W	WTEB-D155D-230 55W
Input voltage (V)	AC 220~240V	
Input frequency (Hz)	50/60 Hz	
Lamp type (Watts, holder)	2D/2C (38W/40W,GR10q)	2D/2C 55W,GR10q-3)
Input current (A)	0.1 ~ 0.25 A	0.1 ~ 0.35 A
Operating Frequency (KHz)	40K ~ 100 KHz	40K ~ 100 KHz
Input power (Watt) Max.	45 W	65 W
Power factor	> 0.97	> 0.98
Lumen coefficient	> 98%	> 98%
THD	< 10%	
Crest factor	< 1.5	
Preheat start-up time (sec)	> 0.4 second	
Environment temperature (Ta)	0°C ~ 50°C	
Case temperature (Tc) Max.	75°C	
Average life time	3 years	
Dimension (mm)	94.2(L) x 94.2(W) x 43(H) mm	
Standards	EMC: EN55015 , EN61547 , EN61000-3-2, EN61000-3-3 Safety: EN61347-1, EN61347-2-3	



## WENTAI TECHNOLOGY CORPORATION

Address: 6F-3,NO.123,LANE 235, Pao-chiao Rd., Shintien city, Taipei, Taiwan  
 Taiwan Head office : Tel: +886 -2-89192318, Fax: +886-2-89192320  
 China office : Tel: +86-755-28025033, Fax: +86-755-28025022  
 E-mail : [sales@a-wentai.com](mailto:sales@a-wentai.com), [sales1@a-wentai.com](mailto:sales1@a-wentai.com)  
 Website : <http://www.a-wentai.com>